



REVE MANICURE TABLE

SKU:483-42



Stunning and state-of-the-art, the Reve Collection is designed to add a touch of elegance and sophistication.

The Reve Manicure Table features sleek lines, clean simple box construction with no visible hardware, making this unit perfect for any salon or spa.

TECHNICAL INFORMATION

- Measures: 42"W x 16"D x 30"H x 36"H
- 1 Full extension drawer
- Storage cabinet w/ adjustable shelf
- Locking casters
- Padder rest
- Lamp
- Sleek, no visible hardware
- Optional: 10633 Valentino powered vent w/ charcoal filter

SHIPPING INFORMATION

Item generally ships via Freight(Truck) service

- Weight: 158 lbs
- Dimensions: 48"L x 32"W x 49"H

WARRANTY

3 Years:

- Ball-Bearing Drawer Slides
- Cabinet hinges

1 Year:

- All remaining components, unless noted otherwise, are guaranteed for a period of one year from the date of purchase.

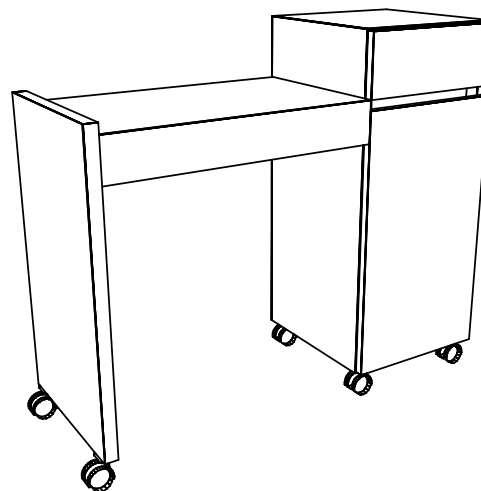
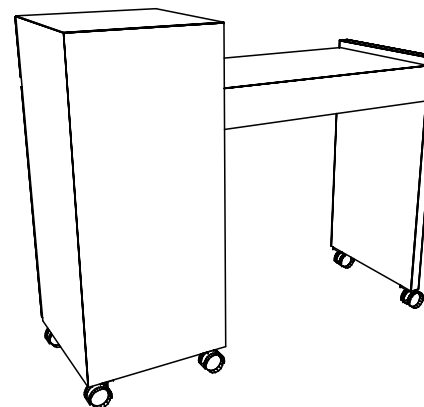
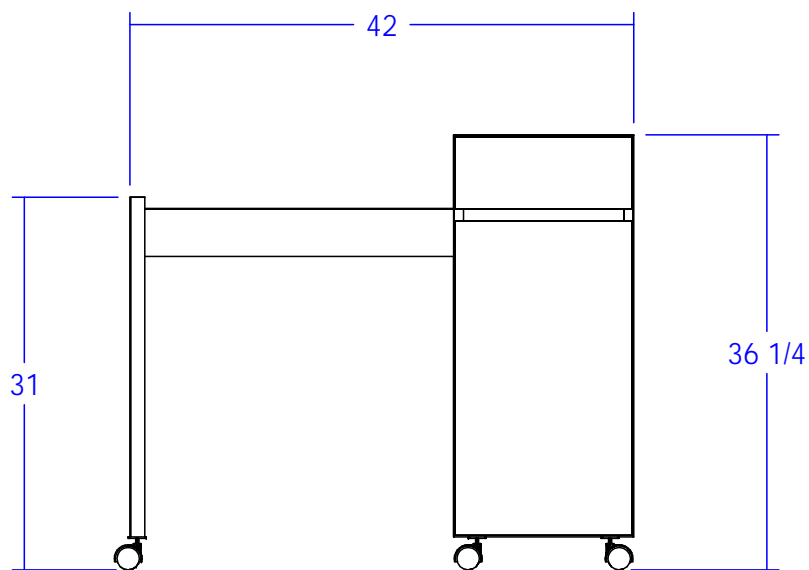
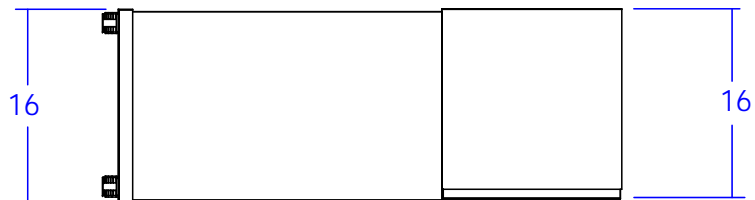

Finish Schedule - 483-42-1	
Face Color -	Cafelle
Top Color -	Cafelle
Toe Color -	Twinwheel Casters
Reveal / Accent Color -	Satin Stainless
Hardware -	N/A
Interior -	Black Melamine
Other (Specify) -	

Includes adjustable lamp & padded upholstered rest, not shown here.

		Collins Manufacturing 2000 Bowser Road Cookeville, TN 38506	
Title: 483-42 Reve Nail Table			
Size: NTS	Drawing Number: 76302		Drawn By: Ben
Date:		Sheet	