



REVE STYLING STATION

SKU:465-48

Stunning and state-of-the-art, the Reve Collection is designed to add a touch of elegance and sophistication.

The Reve Styling Vanity & Ledge features sleek lines, clean simple style with no visible hardware, making this unit perfect for any salon

TECHNICAL INFORMATION

- Measures: 48"W x 16"D x 39"H x 81"H
- Full extension drawer, ball bearing slides
- Storage cabinet w/ adjustable shelf
- 30" x 48" mirror
- Ledge w/ tool holder
 - Blow dryer
 - Curling iron
 - Flat iron

SHIPPING INFORMATION

Item generally ships via Freight(Truck) service

- Weight: 180 lbs
- Dimensions: 58"L x 32"W x 60"H

WARRANTY

3 Years:

- Ball-Bearing Drawer Slides
- Cabinet hinges

1 Year:

- All remaining components, unless noted otherwise, are guaranteed for a period of one year from the date of purchase.



Attach ledge to cabinet by bolting through the interior left side of cabinet into the pre-installed fasteners located in ledge. See instructions below for attaching to wall.

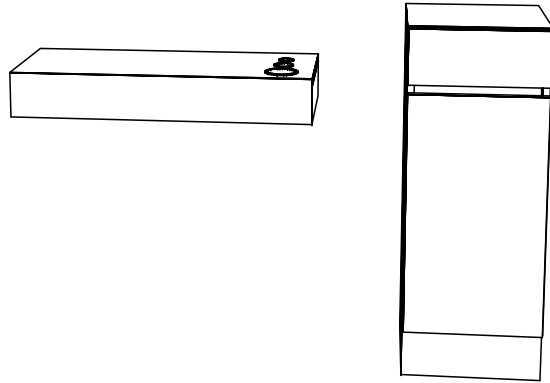

Mount mirror cleats to wall. Cleats should be flush to end of the ledge on both sides. Do not screw in the outside 1 1/2" of cleats as they will be visible after the mirror is mounted.

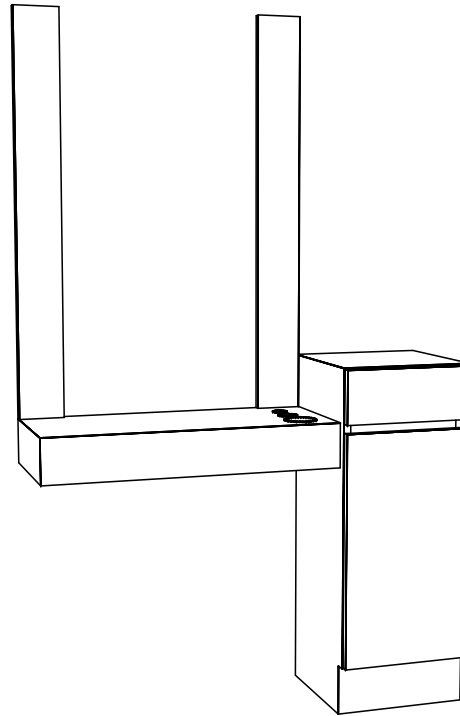

Follow the instructions on mirror clip box to install mirror. Make sure mirror is centered on the ledge.

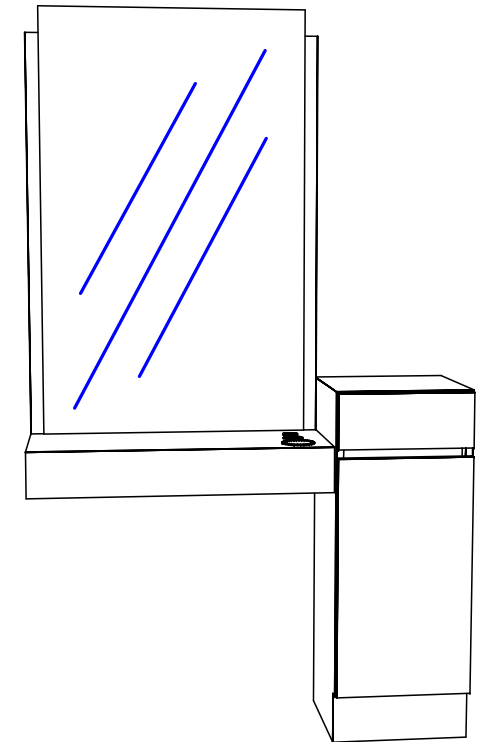

This item is attached to the wall with wood screws. 3" wood screws and decorative washers are provided for wood framed walls. Fasteners for other wall types are to be obtained locally. Screw through the back panel in locations which will be inconspicuous after installation. Suggested locations include: under shelves, behind drawers, and locations hidden by products or supplies.

Quantity -

| |
|---------------------------------|
| Finish Schedule - 465-48 |
| Face Color - |
| Top Color - |
| Toe Color - |
| Reveal / Accent Color - |
| Hardware - |
| Interior - |
| Other (Specify) - |

| |
|---|
| General Notes: |
| 1. All counter tops are to be made removable wherever possible. |
| 2. Items must be broken into manageable sections For Shipping. Mark For Ease Of Reassembly. |
| 3. Install Shipping Cleats Wherever Possible To Prevent Shipping Damage. |
| 4. Purchased items Must Be Trial Fit Before Shipping. |

| | | |
|--------------------------------------|-----------------|---------------|
| collins Collins Manufacturing | | |
| 2000 Bowser Road | | |
| Cookeville, TN 38506 | | |
| Title: | | |
| Size: NTS | Drawing Number: | Drawn By: Eng |
| Date: 06/08/10 | Sheet | |