



MID-TOWN STYLING STATION

SKU:795-51

Our Mid-Town Styling Station is designed after some of NYC's most prominent skyscrapers in that area of the city.

The angled ledge and wave mirror add a very eye-catching element. With its sleek lines and Art Deco inspired design, the Mid-Town Station is suitable for any salon or spa.

TECHNICAL INFORMATION

- Measures: 51"W x 20"D x 93"H
- Tapered cabinet
- Custom wall-mounted framed mirror
- Angled ledge
- Two drawers
- Fully equipped tool panel, power strip, elevated work surface

SHIPPING INFORMATION

Item generally ships via Freight(Truck) service

- Weight: 250 lbs
- Dimensions: 84"L x 32"W x 50"H

WARRANTY

3 Years:

- Ball-Bearing Drawer Slides
- Cabinet hinges

1 Year:

- All remaining components, unless noted otherwise, are guaranteed for a period of one year from the date of purchase.



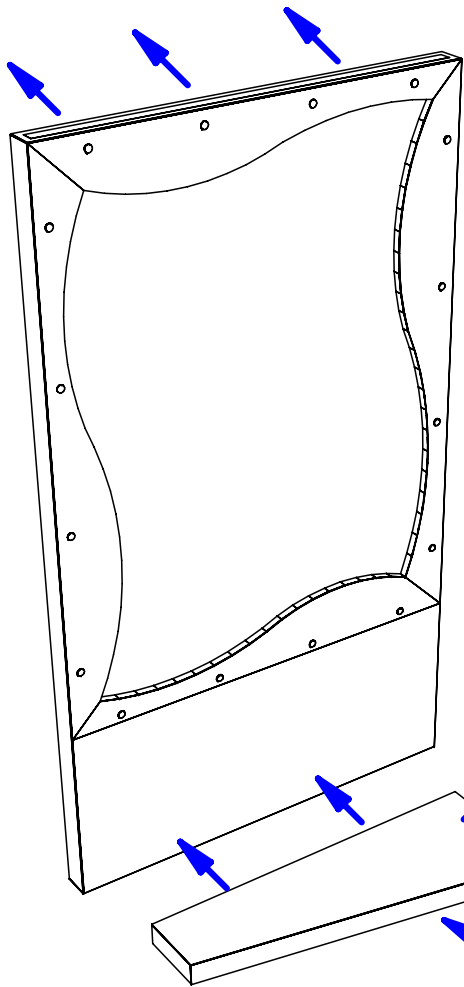

STEP 1. Mount mirror frame to wall by removing lower french cleat from back of frame and mount cleat to wall with (4) 3" wood screws into wall studs. Mount at a height so that when mirror frame is in place the distance from floor to the top of the mirror frame is 93". See diagram 7.

STEP 2. Set cabinet in place (see detail in top right corner). Remove drawers (see diagram 8). Mount cabinet to mirror frame by screwing (4) 1 1/2" wood screws with beauty washers through interior back panel of cabinet into mirror frame.

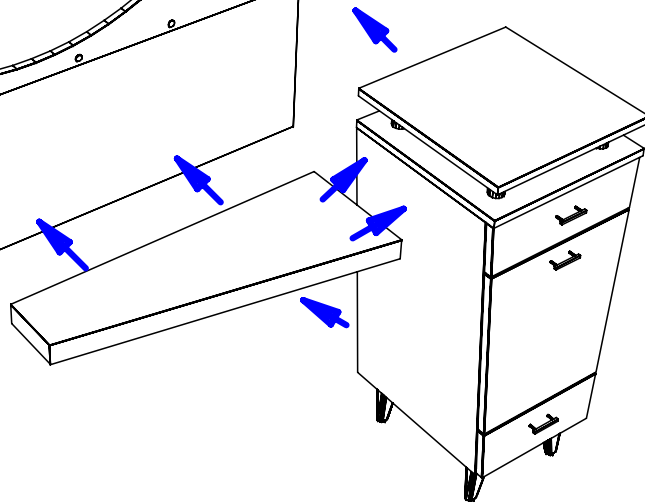

STEP 3. Mount purse ledge to mirror frame with (3) 1 1/4" wood screws through ledge into mirror frame. Mount ledge to cabinet with (2) 1 1/4" wood screws through ledge into cabinet.

Power strip is provided with a 4' grounded cord and (6) 15 amp outlets. Electrician is to cut outlet hole for cord and provide power supply.

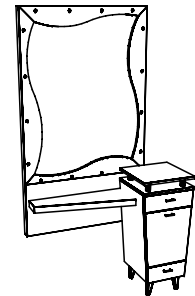
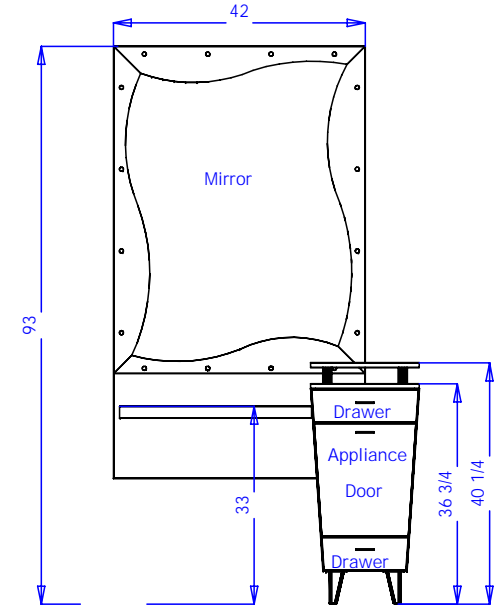
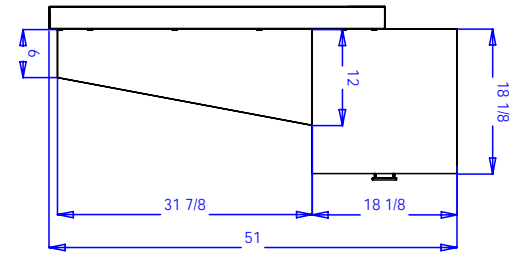

Quantity - Qty

Finish Schedule - 795-51-1

Face Color - Face Color
 Top Color - Top Color
 Toe Color - (Specify)
 Pulls - Chrome Wire
 Interior - White
 Other (Specify) -

Installation Notes:

1. All hardware needed for assembly is included.
2. Large items are preassembled at the factory to ensure proper alignment. Items are then disassembled into manageable sections for shipping purposes and ease of reassembly.
3. Shipping cleats need to be removed before installation. These cleats are installed to prevent damage.

collins		Collins Manufacturing 2000 Bowser Rd. Cookeville TN 38506	
Title: Customer Name			
Size:	#: SoNumber	Drawn By: Engineer	
Date: 09/19/06	Sheet #:		6

Door and drawer pull installation

Remove screws from the front of door/drawer face flip the pull from the inside of door/drawer to the outside reinstall the screws into the pull from inside the door/drawer.

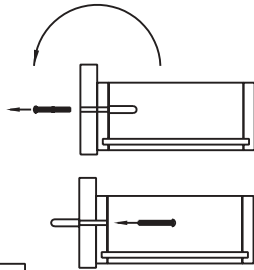

Diagram 1

Lift Lid Installation

Lift lid should be attached to the cabinet by inserting the shoulder bolt through the metal bracket, plastic spacer, and then into the threaded insert in the cabinet side.

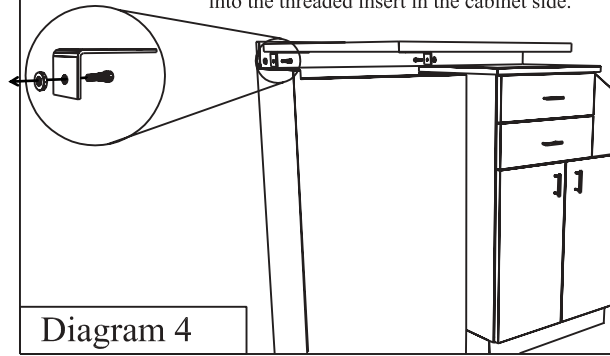

Diagram 4

Remove drawer by releasing the drawer slide lock tab ("fig. 1") Each slide has its own lock tab that must be released to remove drawer.

Removal of drawer is necessary to fasten cabinets together.

Pull drawer slide out

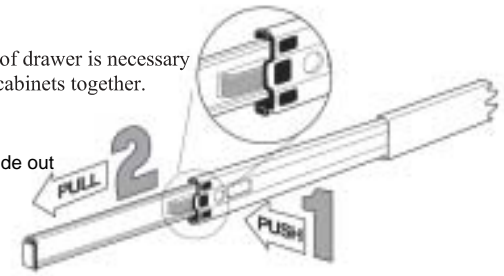
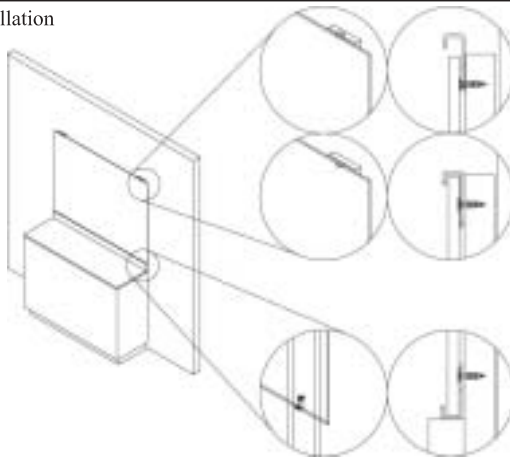

Fig. 1 Move tab up or down

Diagram 8 Drawer Removal

Mirror Installation



Mirrors are provided with mirror clips and wood screws. Attach one mirror clip at each corner approximately 2" in from the vertical edge.

Diagram 2

Purse Ledge Installation

Attach purse shelf to wall with 3" wood screw engaging at least two wall studs. Then attach shelf to the side of the cabinet using 1 1/2" wood screws with beauty washers.

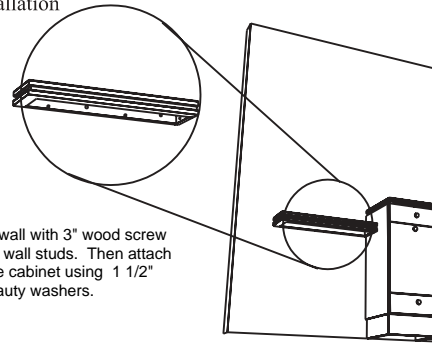
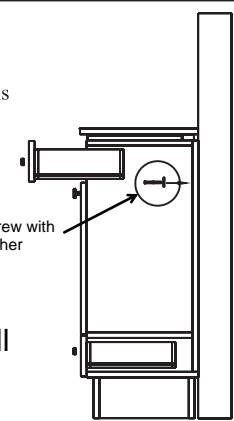

Diagram 5

Cabinets should be attached to wood framed walls by screwing through the interior back panel into wall studs or blocking. Fasteners for wood framed walls are provided. The fasteners for other wall types are not provided.

3" wood screw with beauty washer



Attaching Cabinet to Wall

Diagram 9

BackSplash/ Mending Plate Installation

Backsplashes are sent loose. Backsplashes may be attached by using provided mending plates or by using contractor's adhesive. If using mending plates, attach mending plates to backsplash then to the cabinet using the screws provided. See diagram below.

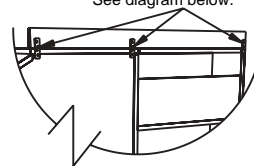
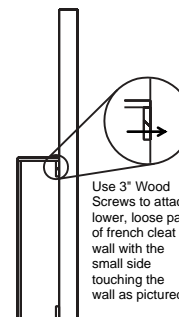

Diagram 6

French cleat detail

French cleat should be attached to the wall by screwing through the cleat into wall stud or blocking using the fasteners provided. The cleat should be level and at the indicated height.

The lower cleat that attaches to the wall is usually loosely attached to the back or inside (unfinished) of the cabinet with one or two wood screws. Remove cleat and mount to wall. The cabinet then hangs, or rests on the wall-mounted cleat as depicted.



Use 3" Wood Screws to attach lower, loose part of french cleat to wall with the small side touching the wall as pictured.

Diagram 7

Hinge adjustment detail

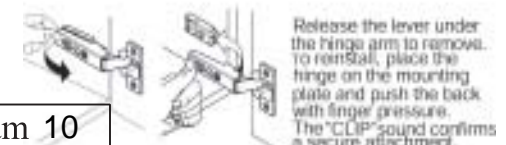
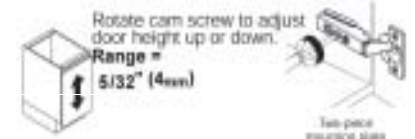
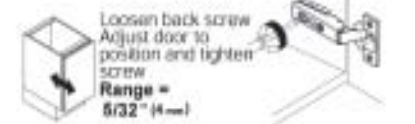
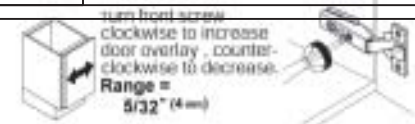
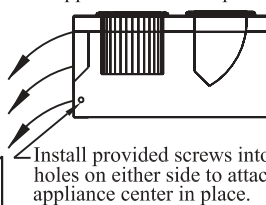

Diagram 10

Appliance Center Installation

Install appliance center onto french cleat mounted on the back of door. Push the appliance center into place firmly then install screws into holes provided to attach and lock appliance center in place.



Install provided screws into holes on either side to attach appliance center in place.

Diagram 3