



LILA DRYER CHAIR

SKU:963-18



With its modern styling, the Lila Dryer Chair will be a standout in your salon. It features a sleek chrome style and a comfortable seat cushion with a slight rise for client comfort.

The beautiful flat armrests and the overall sleek design, adds elegance to any salon setting, while also creating a distinct style for your space.

Includes our cETL certified 1400 Watts dryer, that features ion technology and temperatures reaching 150° F.

TECHNICAL INFORMATION

- Overall size - 24.5"W x 32"D x 48"H
- Width between arms - 20.5"
- Height to seat - 18.5"
- Depth of seat - 19.5"

SHIPPING INFORMATION

Item generally ships via Freight(Truck) service

- Weight: 84 lbs
- Dimensions: 2 cartons measuring 17"x15"x34" and 33"x25"x36"

WARRANTY

7.5 Years:

- Models 3500, 4500, 5550 Foot Operated Hydraulic Pumps

5 years:

- Collins Comfort Zone anti-fatigue mats
- Collins all purpose and shampoo chair back reclining mechanisms
- Models 3250, 4250, 5250 Foot Operated Hydraulic Pumps

3 Years:

- BKB Electric Base

1 year:

- All remaining components, unless otherwise noted

THIS UNIT SHIPS FULLY ASSEMBLED

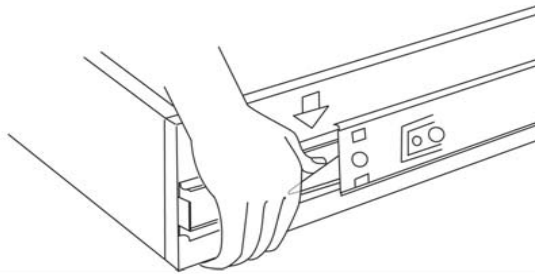

To Remove Drawer

Pull the drawer fully open so levers are visible.
Push "down" on the right lever(shown), and "up" on the left lever.
Holding levers in place, pull drawer toward you.

To Reinsert Drawer

Bring ball retainer fully forward and carefully reinsert drawer member slide into the cabinet member slide, guiding the drawer member raceway between the ball bearings.
Completely close drawer.
Open and close drawer to ensure the slide is fully engaged into the ball bearing track.

For safe operation, please use the included 3" wood screws to attach the cabinet to a framed wall. To conceal the screw heads you may place the screws behind the breadboard / drawers. See the illustration in the upper left corner for proper removal/reinsertion procedure for the drawer slides.

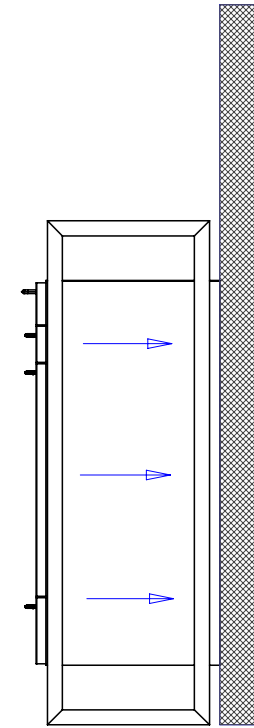

Quantity -

Finish Schedule - 963-18

Face Color -
Top Color -
Toe Color -
Reveal / Accent Color -
Hardware - Enova
Interior -
Other (Specify) -

General Notes:

1. All counter tops are to be made removable wherever possible.
2. Items must be broken into manageable sections For Shipping. Mark For Ease Of Reassembly.
3. Install Shipping Cleats Wherever Possible To Prevent Shipping Damage.
4. Purchased items Must Be Trial Fit Before Shipping.

collins

Collins Manufacturing
2000 Bowser Road
Cookeville, TN 38506

Title:

Size: NTS

Drawing Number: Job

Drawn By: Zane

Date: 10/11/07

Sheet 5 of 5

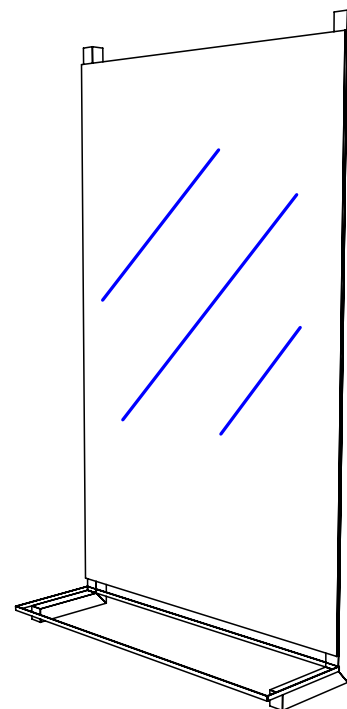
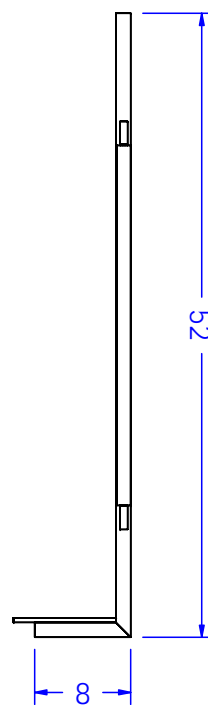
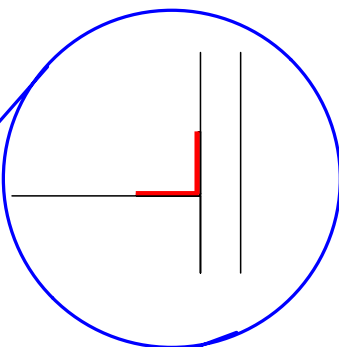
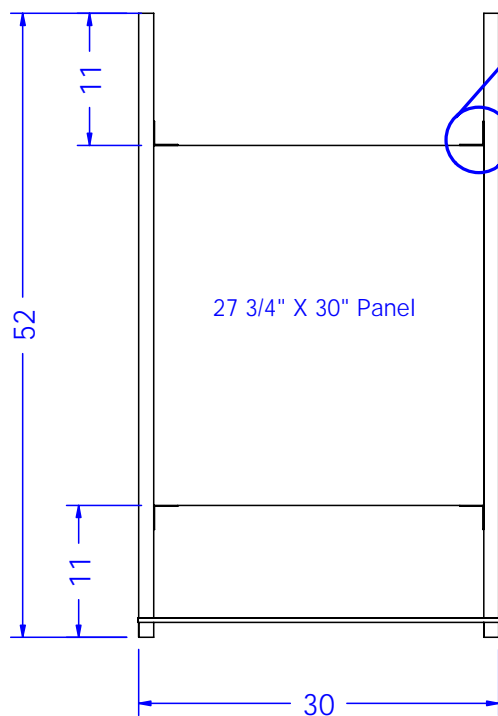
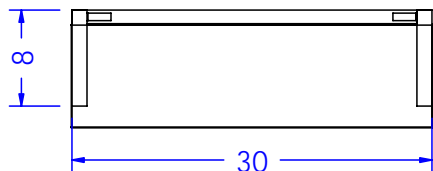

To Assemble Mirror Frame:

- 1) Unit will ship in 3 pieces (left, right and center panel).
- 2) Use provided screws to attach panel to L/R metal pieces by passing through the "L" brackets that ship attached to the panel.
- 3) Once assembled, screw frame to wall using supplied 3" wood screws and finish washers through the center panel.
- 4) Mirror clips will arrive pre-attached. To install mirror set the lower portion of the mirror into the lower clips then lift the upper clips and seat mirror, finally lower the upper clips to lock the mirror in place.

Finish Schedule -

Face Color -
Top Color -
Toe Color -
Reveal / Accent Color -
Hardware -
Interior -
Other (Specify) -

General Notes:

1. All counter tops are to be made removable wherever possible.
2. Items must be broken into manageable sections For Shipping. Mark For Ease Of Reassembly.
3. Install Shipping Cleats Wherever Possible To Prevent Shipping Damage.
4. Purchased items Must Be Trial Fit Before Shipping.

collins Collins Manufacturing
2000 Bowser Road
Cookeville, TN 38506

Title: **962-30 Installation**

Size: Drawing Number: Drawn By:

Date: Sheet