



BRADFORD STYLING STATION

SKU:881-30

Bradford Styling Vanity w/ lazy Susan mirror features detailed molding.

TECHNICAL INFORMATION

- Measures: 30"W x 13"D x 72"H
- Lazy Susan mirror
- Storage shelves on back side of mirror
- Pull-out breadboard
- Two drawers
- Tool cabinet
 - Blow dryer
 - Curling iron
 - Flat iron
 - Clippers
- Queen Anne legs
- Crown and accent molding
- Optional-Claw & Ball legs w/ Dentil molding in lieu of Queen Anne

SHIPPING INFORMATION

Item generally ships via Freight(Truck) service

- Weight: 290 lbs
- Dimensions: 48"L x 32"W x 62"H

WARRANTY

3 Years:

- Ball-Bearing Drawer Slides
- Cabinet hinges

1 Year:

- All remaining components, unless noted otherwise, are guaranteed for a period of one year from the date of purchase.



Two or more people are required for assembly.

Step 1: Set base in place. Make sure base is level. Use the provided 3" wood screws and beauty washers to attach to wood framed wall.

Step 2: Carefully place upper cabinet onto base. Attach the upper cabinet to the wall by screwing through the interior backs with the provided 3" wood screws and beauty washers. Attach upper cabinet to base by bolting through the interior bottoms of each side of the upper cabinets into pre-installed fasteners in the base. Use the 4 provided 1 1/2" decorative bolts.

Step3: Carefully place crown molding cap over the upper cabinet. Use the provided 1 1/2" wood screws to attach cap. Screw through top of cap into top corners of cabinet.

This item includes a six outlet power strip with a 4' cord. The outlet strip is rated at 15 amps. The electrician is responsible for providing and mounting an outlet inside the cabinet for the power strip to plug into. The electrician is also responsible for cutting an appropriate entry point for getting power into the cabinet.

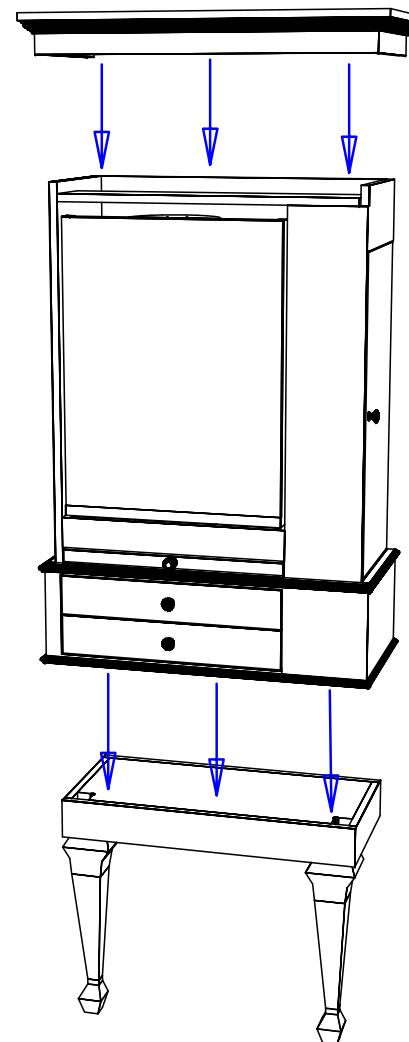
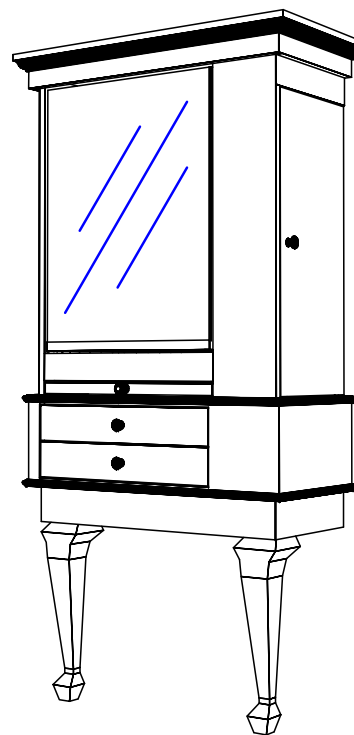

Quantity -

Finish Schedule - 881-30-1

Face Color -
Top Color -
Toe Color -
Reveal / Accent Color -
Hardware -
Interior -
Other (Specify) -

General Notes:

1. All counter tops are to be made removable wherever possible.
2. Items must be broken into manageable sections For Shipping. Mark For Ease Of Reassembly.
3. Install Shipping Cleats Wherever Possible To Prevent Shipping Damage.
4. Purchased items Must Be Trial Fit Before Shipping.

collins Collins Manufacturing
2000 Bowser Road
Cookeville, TN 38506

Title:

Size:

Drawing Number:

Drawn By:

Date:

Sheet