



## BRADFORD II STYLING ISLAND

SKU:881-46



With the Bradford Back-To-Back Styling Island you can design the perfect space. Create a classic and stylish accent in your salon with crown molding details that enrich the space by forming an eye-catching transition between the walls and ceiling. The Queen Anne legs detail make this a timeless piece that will not go out of style. This traditional style can fit into any decor with just the change of the laminate color.

### TECHNICAL INFORMATION

---

- Measures: 46"W x 26" D x 78"H
- Queen Anne legs
- Accent molding
- Two 881-42 Bradford Vanities
  - Back-to-back
  - 4 Legs
- Optional-Claw & Ball legs w/ Dentil molding in lieu of Queen Anne legs

### SHIPPING INFORMATION

---

Item generally ships via Freight(Truck) service

- Weight: 600 lbs
- Dimensions: 2 skids

### WARRANTY

---

#### 3 Years:

- Ball-Bearing Drawer Slides
- Cabinet hinges

#### 1 Year:

- All remaining components, unless noted otherwise, are guaranteed for a period of one year from the date of purchase.

Two or more people are required for assembly.

Step 1: Set base in place. Take care when placing base, once unit is assembled it will be very heavy and can not be moved.

Step 2: Carefully place upper cabinets onto base. Attach the upper cabinets together by bolting through the interior backs with the 8 provided 1 1/4" decorative bolts and connectors. Attach upper cabinets to base by bolting through the interior bottoms of each side of the upper cabinets into pre-installed fasteners in the base. Use the 4 provided 1 1/2" decorative bolts.

Step 3: Carefully place crown molding cap over the upper cabinets. No fasteners are necessary to hold cap in place.

**Note:** A power strip is provided for each cabinet with a 4' grounded cord and (6) 15 amp outlets. Electrician is to cut outlet hole for cord and provide power supply.

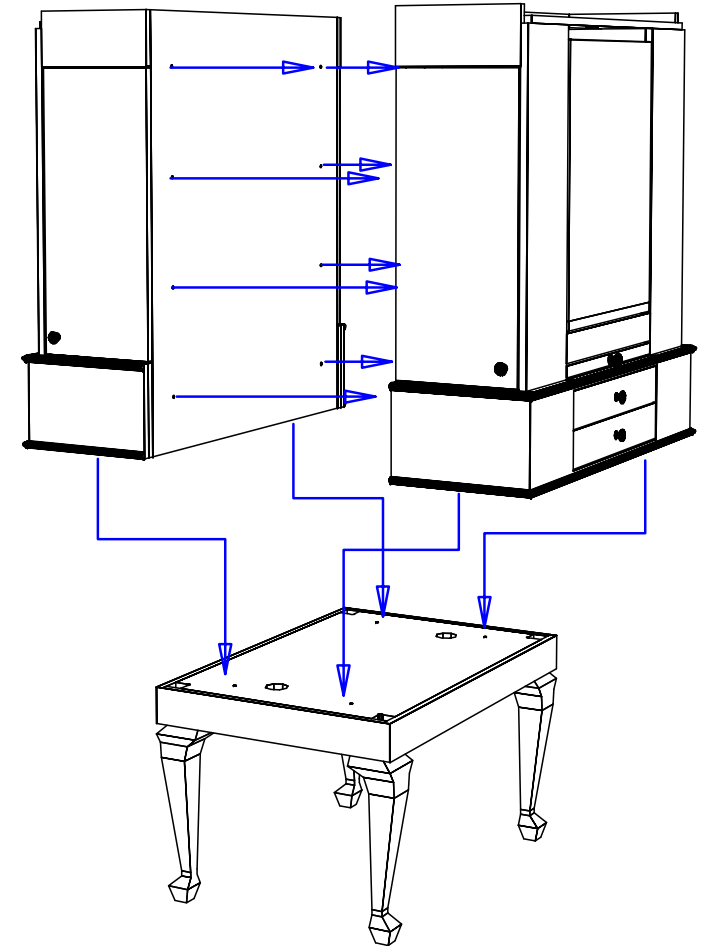
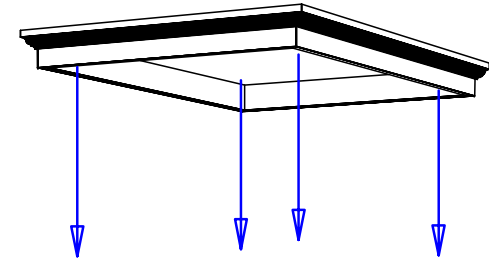
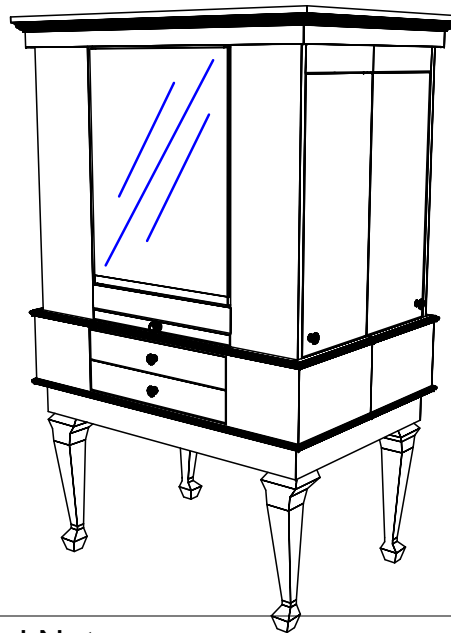

Quantity -

Finish Schedule - 881-46-1

Face Color -  
Top Color -  
Toe Color -  
Reveal / Accent Color -  
Hardware -  
Interior -  
Other (Specify) -

### General Notes:

1. All counter tops are to be made removable wherever possible.
2. Items must be broken into manageable sections For Shipping. Mark For Ease Of Reassembly.
3. Install Shipping Cleats Wherever Possible To Prevent Shipping Damage.
4. Purchased items Must Be Trial Fit Before Shipping.

**collins**

Collins Manufacturing  
2000 Bowser Road  
Cookeville, TN 38506

Title:

Size:

Drawing Number:

Drawn By:

Date:

Sheet