



## ENOVA CE PORTABLE STYLING STATION

SKU:959-15

Create the ideal space for your creative needs with this Enova CE Portable Styling Station. With its modern design and smooth lines, it is a beautiful addition to any salon.

With extra drawer storage and ample space on the top, this piece gives you lots of options for storing styling tools. The top is surrounded on three sides to keep your most-used items in place and not falling off the top.

### TECHNICAL INFORMATION

- Measures: 15 1/2"W x 15"D x 35"H x 38"H
- Industrial casters
- Pull-out breadboard
- Two drawers
- Tilt-out tool panel
  - Six-outlet power strip
  - Blow dryers
  - Flat iron
  - 1" Curling iron
  - 2" Curling iron
  - Clippers

### SHIPPING INFORMATION

Item generally ships via Freight(Truck) service

- Weight: 252 lbs
- Dimensions: 60"L x 30"W x 56"H

### WARRANTY

#### 3 Years:

- Ball-Bearing Drawer Slides
- Cabinet hinges

#### 1 Year:

- All remaining components, unless noted otherwise, are guaranteed for a period of one year from the date of purchase.



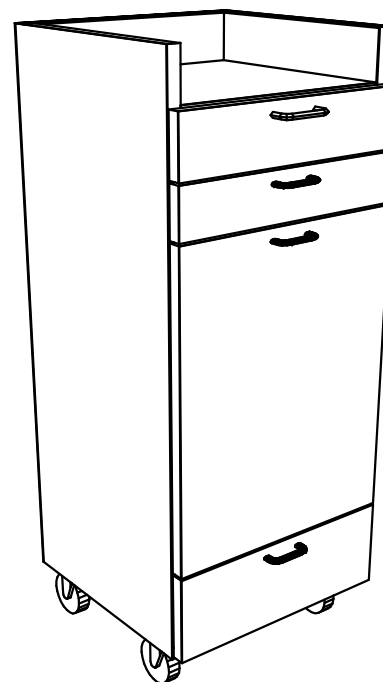
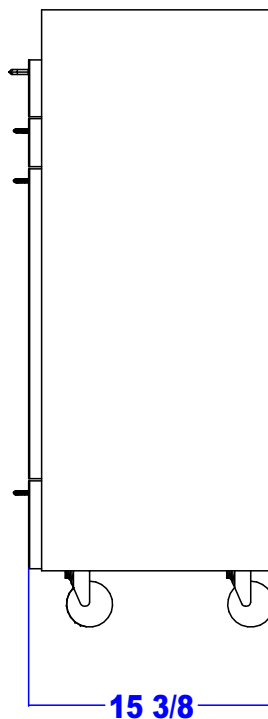
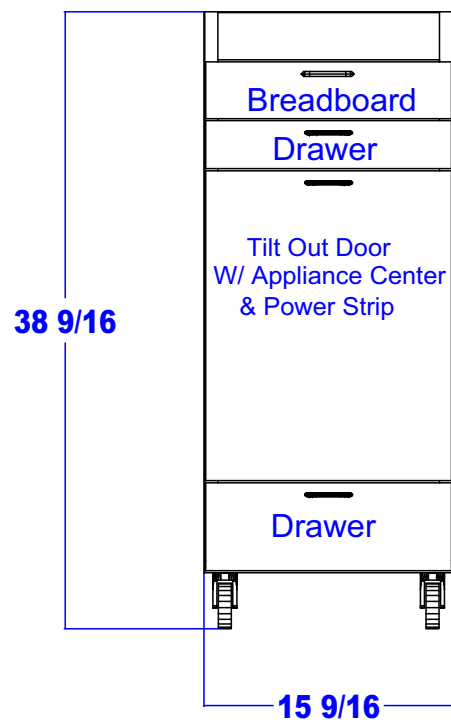

**Ships Fully Assembled**

### Finish Schedule – 959-15-1

Face Color -  
Top Color -  
Toe Color - Industrial Casters  
Reveal / Accent Color -  
Hardware - Enova Pulls  
Interior - Black/Cherry  
Other (Specify) -

### General Notes:

1. All counter tops are to be made removable wherever possible.
2. Items must be broken into manageable sections For Shipping. Mark For Ease Of Reassembly.
3. Install Shipping Cleats Wherever Possible To Prevent Shipping Damage.
4. Purchased items Must Be Trial Fit Before Shipping.

<b>collins</b> Collins Manufacturing 2000 Bowser Road Cookeville, TN 38506		
Title: <b>959-15 Enova Portable</b>		
Size: <b>NTS</b>	Drawing Number: <b>73335</b>	Drawn By: <b>Brian</b>
Date:		Sheet