



ENOVA AR STYLING ISLAND

SKU:964-66



From the Enova collection, this modern Styling Island includes all your favorite features you need for styling. The island, made for two stylist, back-to-back, showcases beautiful steel sides on each vanity that help keep items from falling from the surface work space and also extend to the floor for a dramatic look.

Double mirror and glass ledge for each side included as pictured.

TECHNICAL INFORMATION

- Measures: 66"W x 28"D x 84"H
- 2 back-to-back 962-30 Enova AR mirror assembly, as pictured
- 2 fully equipped 963-18 Enova AR Styling Vanities

SHIPPING INFORMATION

Item generally ships via Freight(Truck) service

- Weight: 407 lbs
- Dimensions: 2 SKIDS

WARRANTY

3 Years:

- Ball-Bearing Drawer Slides
- Cabinet hinges

1 Year:

- All remaining components, unless noted otherwise, are guaranteed for a period of one year from the date of purchase.

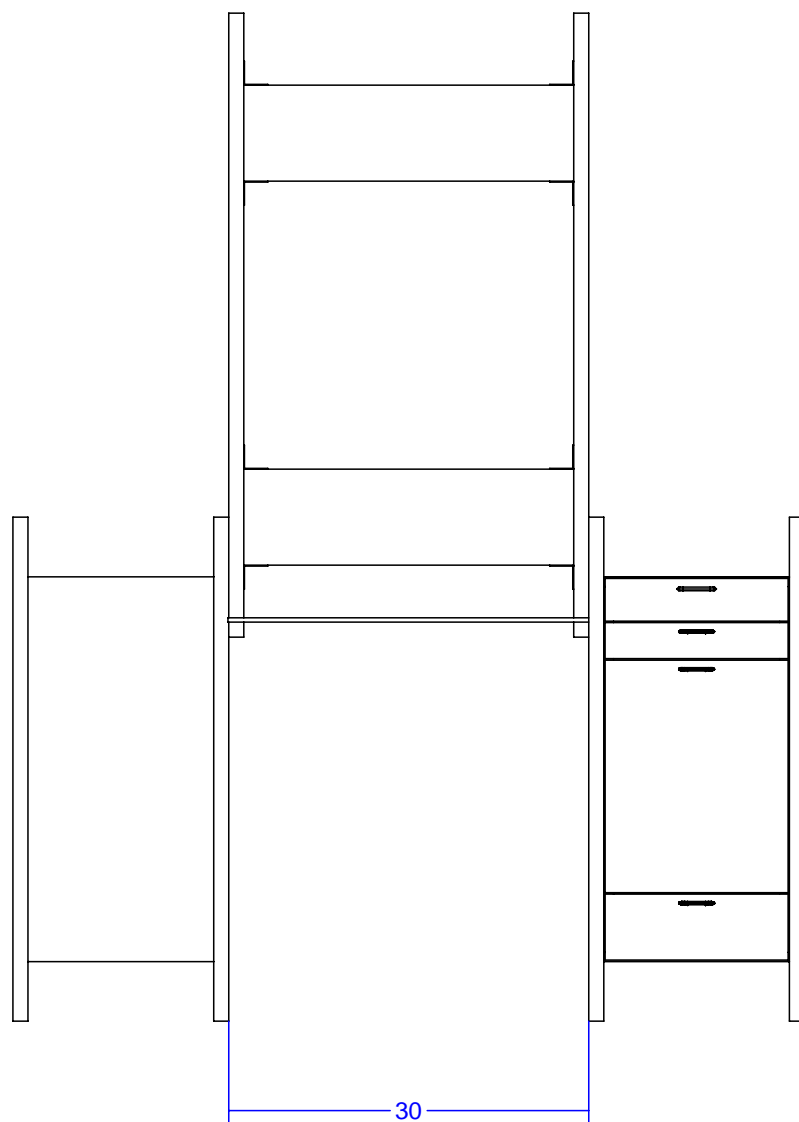

Your shipment should arrive as (2) lower cabinets, (1) disassembled double mirror frame, (2) mirrors and (2) glass ledges. Follow the following steps to assemble the island.

1) Assemble the mirror frame by lining up the L/R ends to the filler panel and screw the provided hardware through the "L" brackets into the metal legs on the L/R ends.

2) Place the two stations 30" apart as shown in the diagram. With the mirrors NOT installed, line up the holes in the mirror frame with the holes in the metal frame of the stations and use the supplied connector bolts to secure both sides with the supplied allen wrench.

3) After all components are securely attached, install the mirror clips on the mirror frame using the supplied screws and the pre-drilled holes. To install the mirror, first seat the bottom of the mirror in the clips then raise the upper clips and seat the top of the mirror, once seated lower the clips to hold the mirror in place.

Finish Schedule - 964-66

Face Color -
Top Color -
Toe Color -
Reveal / Accent Color -
Hardware -
Interior -
Other (Specify) -

General Notes:

1. All counter tops are to be made removable wherever possible.
2. Items must be broken into manageable sections For Shipping. Mark For Ease Of Reassembly.
3. Install Shipping Cleats Wherever Possible To Prevent Shipping Damage.
4. Purchased items Must Be Trial Fit Before Shipping.

collins Collins Manufacturing
2000 Bowser Road
Cookeville, TN 38506

Title: **964-66 Assembly**

Size: NTS Drawing Number: Job Drawn By: Zane

Date: 10/11/07 Sheet 7 of 7

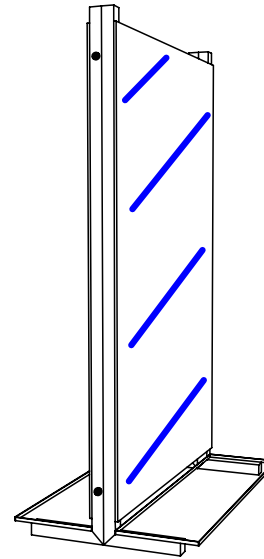
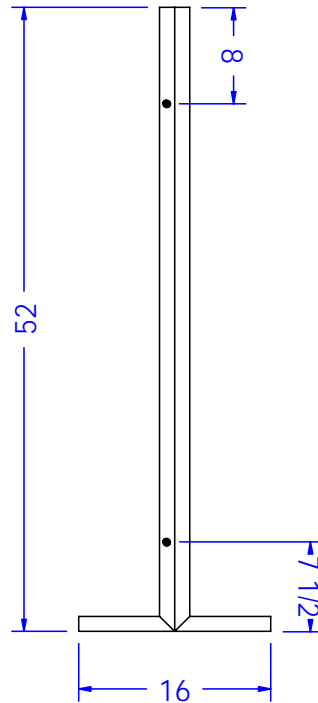
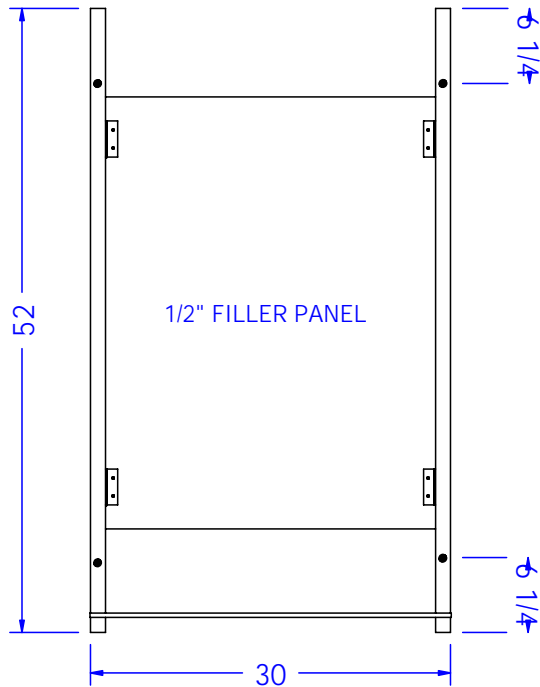
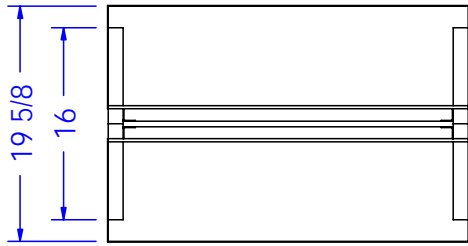

Left End

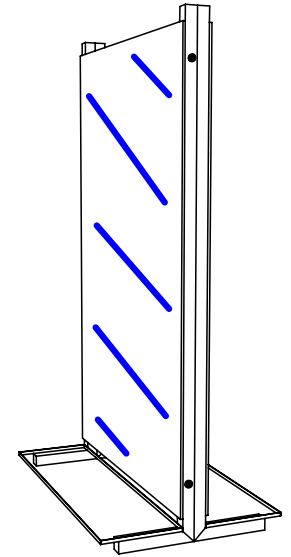

Right End

These drawings show the orientation of the holes drilled in the metal frame for attachment to the individual stations. Also note the placement of the preinstalled brackets on the wood panel. To attach the L/R of the mirror frame to center panel drive screws into the predrilled holes.

Quantity -

Finish Schedule -

Face Color -
Top Color -
Toe Color -
Reveal / Accent Color -
Hardware -
Interior -
Other (Specify) -

General Notes:

1. All counter tops are to be made removable wherever possible.
2. Items must be broken into manageable sections For Shipping. Mark For Ease Of Reassembly.
3. Install Shipping Cleats Wherever Possible To Prevent Shipping Damage.
4. Purchased items Must Be Trial Fit Before Shipping.



Collins Manufacturing
2000 Bowser Road
Cookeville, TN 38506

Title: **Enova B2B Mirror Assy**

Size: Drawing Number: Drawn By:

Date: Sheet