



## BRADFORD RECEPTION DESK

SKU:887-60



With the Bradford Reception Desk you can design the perfect space. Create a classic and stylish accent in your salon or spa with crown molding details that enrich the space by forming an eye-catching transition between the walls and floor. The Wainscoting and Queen Anne legs detail make this a timeless piece that will not go out of style. This traditional style can fit into any decor with just the change of the laminate color.

### TECHNICAL INFORMATION

- Measures: 60"W x 24"D x 43"H
- Queen Anne legs
- Raised panels
- Crown molding
- Accent molding
- Locking cash drawer
- 2 Storage cabinets
- Cash till
- Utility drawer
- Optional - Claw & Ball legs w/ Dentil molding in lieu of Queen Anne legs

### SHIPPING INFORMATION

Item generally ships via Freight(Truck) service

- Weight: 390 lbs
- Dimensions: 72"L x 32"W x 55"H

### WARRANTY

#### 3 Years:

- Ball-Bearing Drawer Slides
- Cabinet hinges

#### 1 Year:

- All remaining components, unless noted otherwise, are guaranteed for a period of one year from the date of purchase.



This cabinet is shipped fully assembled.  
No further assembly or installation is required.

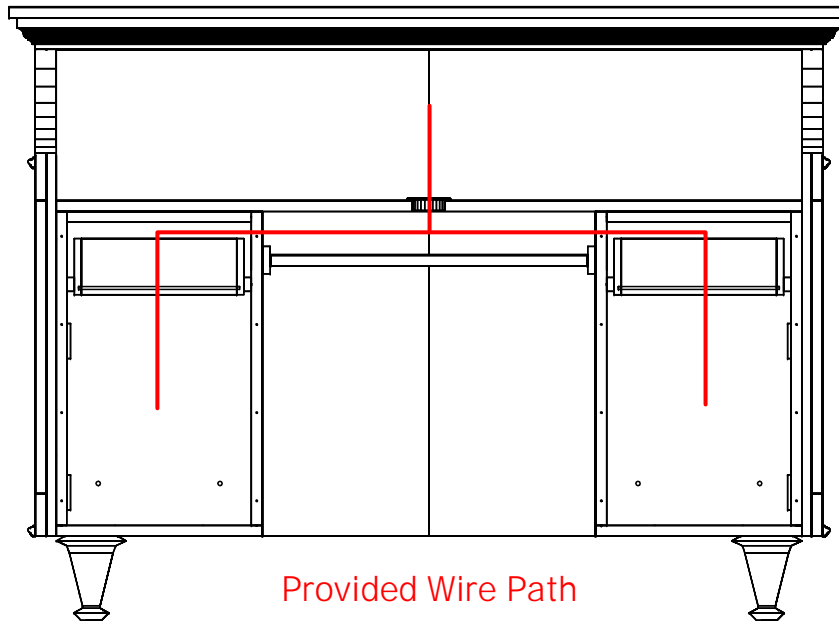
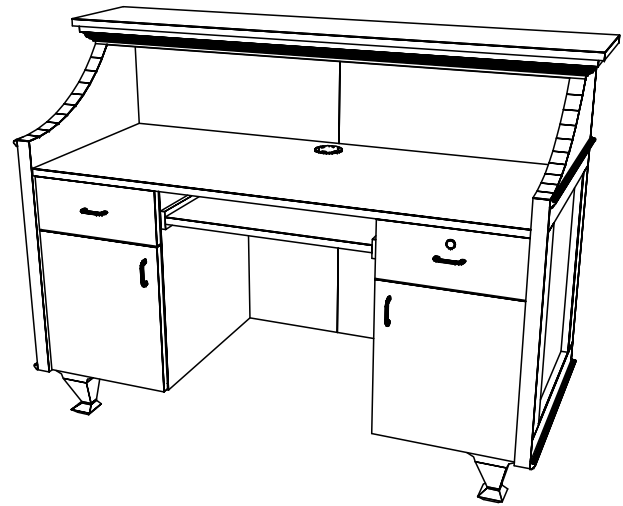

Provided Wire Path

#### Quantity -

Finish Schedule - 887-60

Face Color -  
Top Color -  
Toe Color -  
Reveal / Accent Color -  
Hardware -  
Interior -  
Other (Specify) -

#### General Notes:

1. All counter tops are to be made removable wherever possible.
2. Items must be broken into manageable sections For Shipping. Mark For Ease Of Reassembly.
3. Install Shipping Cleats Wherever Possible To Prevent Shipping Damage.
4. Purchased items Must Be Trial Fit Before Shipping.

**collins**

Collins Manufacturing  
2000 Bowser Road  
Cookeville, TN 38506

Title:

Size: NTS

Drawing Number: Job

Drawn By:

Date: 12/04/07

Sheet 5 of 6